

☐ Troubleshooting

If the screwdriver does not work properly, check the list below. If you cannot solve the problem do not open the unit.

Contact one of our authorized agents as soon as possible.

- If the screwdriver does not run
 - Check the outputting power
 - Check the plug is inserted properly and outlet has output.
 - Check for a open or short circuit in AC wire. If an open or short circuit is found change the AC wire.
 - Check that the carbon brush is undamaged, that the carbon brush guide cord with he rotor to become too small. Anyone of these factors could cause the screwdriver stop rotate abnormally. Inspection method: Open the carbon brush cover and use a non-conductive insulated rod to gently press the brush. If the screwdriver resumes rotating, the carbon brush has reached the end of its useful life and must be replaced immediately.
- If the screwdriver is not rotating normally
 - Long-term used causes the motor’s commutator to wear down. In this case, it must be replaced. (This repair must be performed by one of our authorized agents)
- If the bit falls out easily or wobbles:
 - Check that the bit matched our specifications. If not, change the bit to one that does.
 - If the bit tends to wobble, remove the bit, rotate it 60 or 180 degrees and re-insert it.
- If the screwdriver does not stop when the selected torque is reached.
 - An excessive torque setting can cause the screw to strip the threads, with the result that the clutch does not activate. Lower the torque to a level that does not cause stripping.
 - Differences in size between the bit tip and screw slot lengths can cause slipping. Change to a suitable bit tip.
 - If a malfunction occurs in the braking system, the break will not engage normally. (This repair must be performed by one off our authorized agents)

☐ Warranty

We provide a one-year free repair service warranty with this product. The warranty is good for one year from the date off purchase entered on the Product Information Form. The retailer’s stamp must appear on the form to confirm the date, However, under the following circumstances we will charge the user for any parts and labor costs associated with repair.

- For repairs involving normal wear to parts including carbon brushed, bits and AC wire, and also to the exterior surface.
- If the screwdriver was connected to a power source of the incorrect voltage.
- If there was inappropriate use or an attempt to repair the unit by the user.
- After the period of the guarantee, or if the user cannot present the manual with stamped product Information Form.

Retailer’s Stamp	
-------------------------	--

© Specifications and design may be changed without notice for improvement(A-3)

ASA Industrial Electric Screwdriver User’s Manual
(for full-automatic disk-brake models-high volt. DC motor)

☐ A Word of Thanks to Our Customer

Thank you for choosing lightweight and powerful ASA electric screwdrivers. In order to insure maximum performance and product life, please read through this manual before using your screwdriver.

☐ Features

- Our screwdrivers are designed for use with precision torque locking screws. It can be used for assembly of large items such as home appliances, hardware, computer, furniture and other products.
- Low vibration, low noise, meets environmental protection demands.
- Disk-braking design for low breakdown rate and long product life.
- Screwdrivers can be provided with a pistol-type handle for added safety and convenience.
- Ergonomically designed exterior reduces work fatigue and increases productivity.
- Screwdrivers can be plugged into ordinary household electrical outlets, and are easy to carry.

☐ Specifications

Model	AD-5681	AD-5682	AD-7681	AD-7682	AD-8681	AD-8682
	AD-5681S	AD-5682S	AD-7681S	AD-7682S	AD-8681S	AD-8682S
Power source	AC110/120V 60HZ	AC220/240V 50HZ	AC110/120V 60HZ	AC220/240V 50HZ	AC110/120V 60HZ	AC220/240V 50HZ
Torque range kgf-cm/lbf-in	8.0-25.0 / 6.9-21.7		10.0-30.0 / 8.7-26.0		20.0-50.0 / 17.3-43.4	
Torque accuracy	±3%					
No load speed rpm	750	1000	750	1000	550	750
Torque setting	Stepless					
Available screw	Machine Screw mm/in	3.0-4.5 / 0.12-0.18		3.0-5.0 / 0.12-0.2		4.0-6.0 / 0.16-0.24
	Tapping Screw mm/in	3.0-4.0 / 0.12-0.16		2.6-4.0/0.1-0.16		3.5-5.0 / 0.14-0.20
Weight g / lb	740 / 1.6					
Length mm / in	269 / 10.6					
Available bit shank	5 φ / 5mm Hex shank (AD-5681/82 only) · 1/4” (6.35) Hex shank					
Power consumption W	50					
Clutch impact	Just one time when torque up					

☐ Outline

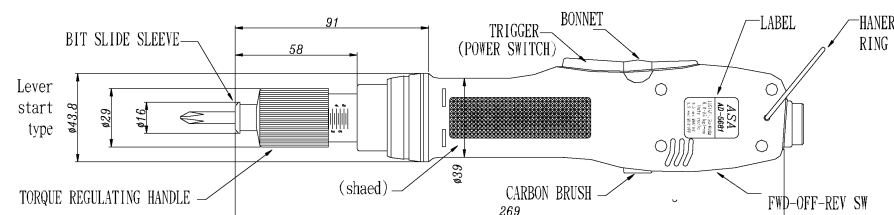

Accessories

This product comes supplied with one AC wire, a pair of carbon brushes and two bits.

- Bits (one set per screwdriver)

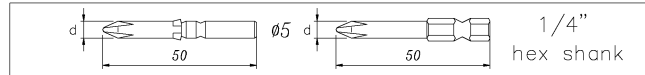

Bit specifications						Available Screwdriver Model
φ 5.0			1/4" Hex Shank			
Tip No.	Tip D	P#	Tip No.	Tip D	P#	
#2	φ 5.0	7W3864	#2	φ 4.5	7W6764	AD-5681/S
#2	φ 5.0	7W3864	#2	φ 6.0	7W6964	AD-5682/S
#2	φ 5.0	7W3864	#2	φ 4.5	7W6764	AD-7681/S
#2	φ 5.0	7W3864	#2	φ 6.0	7W6964	AD-7682/S
			#2	φ 6.0	7W6964	AD-8681/S
			#2	φ 6.0	7W6964	AD-8682/S

Before use, read the following:

- Use the correct voltage: Carefully check the voltage shown on the screwdriver and this manual and determine the correct voltage. Only plug the unit into a power source of the correct voltage.
- Determine the appropriate torque range: Choose the correct screwdriver for the torque you will require. To lengthen product life, avoid long-term high torque use.
- Make sure the screwdriver is undamaged: if the AC wire is scraped or damaged, it should be immediately unplugged and replaced to avoid electric shocks or a short circuit that could result.
- Use in an appropriate work environment: To ensure safety, do not use in high temperature, high humidity environments or near flammable materials. Keep the AC wire away from tools of equipment that might scrape or melt it.
- When plugging in or unplugging the AC wire, hold the plug firmly. Never pull on the wire.

Method of operation and important points

- Brace fastened objects securely: Brace fastened objects securely: Before operation, determine the appropriate torque, refer to "Torque settings" item and adjust the screwdriver to the appropriate torque. Make sure that the fastened objects are securely braced, and then begin operation. This procedure will avoid hazardous rapid rotation of the fastened objects due to excessive torque or insufficient bracing.
- Driving and removing screw:: Before operation, set the forward/reverse switch properly. To drive a screw, set the switch to the forward (FOR) position. To remove a screw, set it to the reverse (REV) position. Press the screwdriver onto the screw perpendicularly to begin operation.
- Torque settings: Use the regulating handle to set the torque. Turning it in a clockwise direction into the screwdriver will increase the torque. Turning it counterclockwise out of the screwdriver torque screwdriver.
- Bit insertion: Use your finger to depress the slide sleeve into the screwdriver and inset an appropriate bit. When the slide sleeve is released, the bit will be automatically engaged.

Note: Do not hammer the bit in or pull it out forcibly.

- Secure screwdriver during operation: During operation, hang the screwdriver up securely (as from balancer) in order to prevent it from being knocked down and suffering external cracking, internal damage, or a snapped AC wire.
- Start and stop: Screwdrivers are pressure-operated. When the screwdriver is pressed onto a screw perpendicularly, inward pressure from the screwdriver bit engages the power switch, and the motor begins running. When the pressure on the screwdriver is released, the bit and power switch revert to original positions and the motor stops running.
- When the selected torque is reached: This product features an internal clutch assembly. When a screw is driven and the selected torque is reached, the clutch assembly will automatically disengage and a 'click' will be heard. At this point, even if you keep the pressure on the screwdriver, the power to the motor will be automatically cut off. Note: when driving screw, grasp the screwdriver firmly in order to prevent upwards recoil generated by the clutch release from forcing the screwdriver bit edge from forcing the screwdriver bit edge from the screw slot and damaging slot.
- When removing screws: When a previously driven screw cannot be removed using the same torque that it was driven with, raise the torque setting. After the screw is removed, return the regulating handle to its original setting. To simplify this operation, note the number of 'click' sounds generated as the regulating handle is turned.

Note: when removing a screw, if the required torque is higher than the screwdriver's output torque, the clutch may not disengage, causing the user's hand and arm to be twisted. In this case immediately set the forward / reverse switch to 'STOP' to cut the motor power and prevent injury.

- Operational frequency: suggest the operational frequency 1/4" (ON/OFF) second, the total screws 7000pcs/8hours, don't over our operational frequency suggest, and avoid the inside part of screwdriver serious damage. If everyday work 8hours upward, please use two screwdriver by turns, protect the life of screwdrivers.
- Change the carbon brush: If the carbon brush requires changing, open the carbon brush cover by turning counterclockwise with a coin or standard screwdriver (width 5-7mm). Remove the used carbon brush and insert a new carbon brush of the same specifications in the empty space. To complete the operation, close the carbon brush cover tightly by turning it clockwise.

Note:

- When changing the carbon brush first unplug the screwdriver. Use a factory specification carbon brush.
- The notch on the carbon brush surface must face into the direction of the rotor rotation.

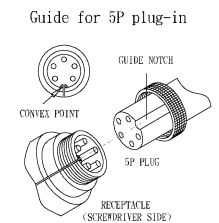
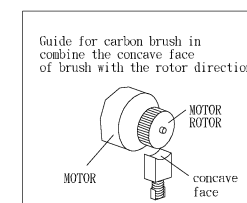
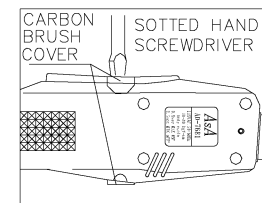

After use

Storage and maintenance: When the unit is to be stored for a long period, remove the bit, open the carbon brush cover and blow out any accumulated carbon brush dust with compressed air, and wipe the exterior clean. Then store the screwdriver carefully in a dry, dust-free place away from direct sunlight. Store the bit in grease. To ensure continued serviceability, periodically check and maintain the screwdriver.

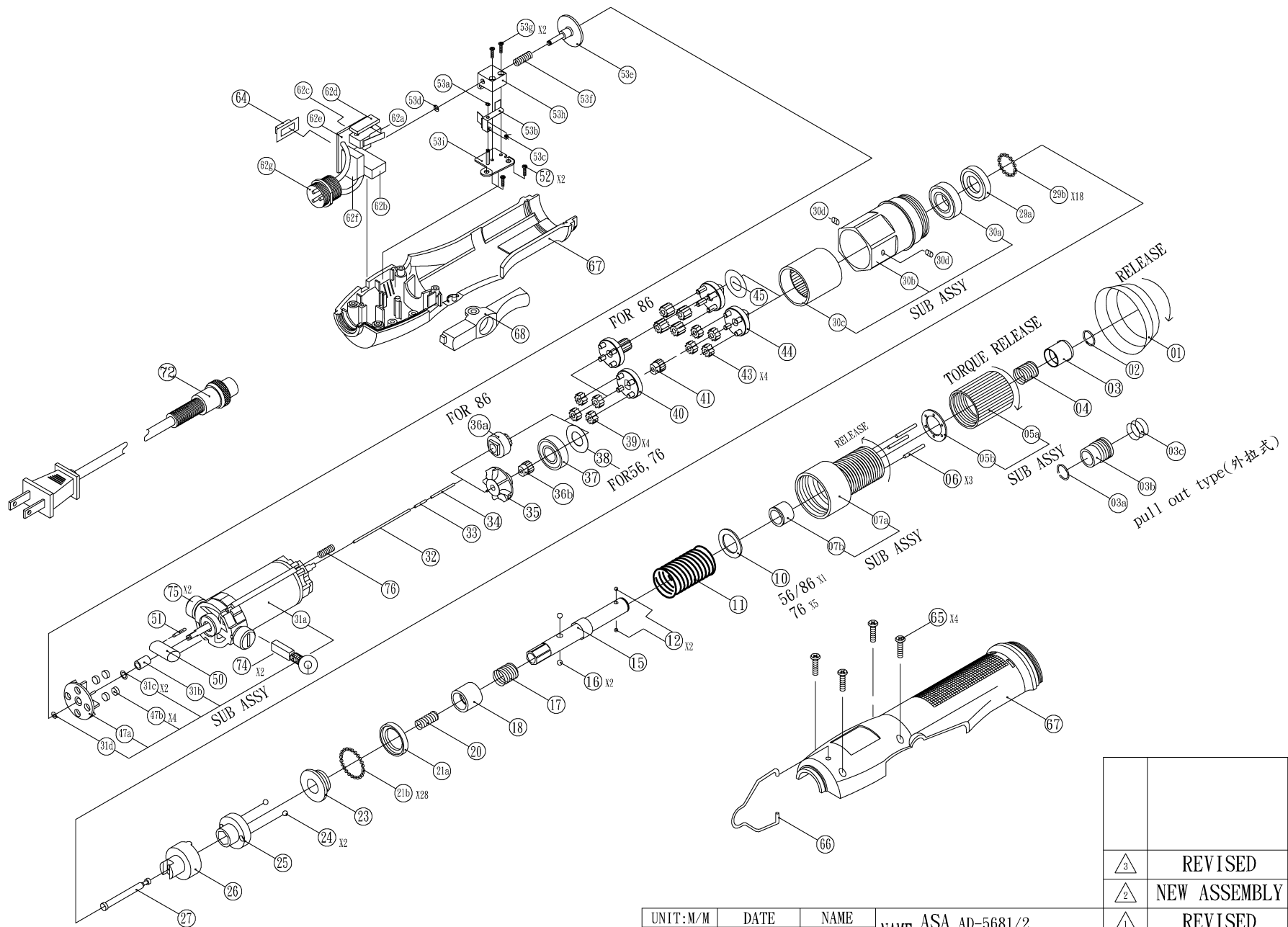

UNIT: M/M	DATE	NAME	NAME ASA AD-5681/2 7681/2, 8681/2 disassemble graphic
DESIGN			
DRAWN	2005. 06. 05	C. C. Y	
CHECKED			
APPROVED	2005. 06. 05	C. C. Y	ASA ENTERPRISE CORP. TEL: (02)8751-0022(10 Line)

3	REVISED	12. 25' 06	L. I. C
2	NEW ASSEMBLY	07. 09' 01	Huang
1	REVISED	11. 30' 00	Huang
SYM	DESCRIPTION	DATE	SIGN

DWG. NO: M10006